



amesys
BEN

ALIZE

ELECTROMAGNETIC SPEED LOG



The ALIZE E/M Speed Log reflects incomparable experience in field of ship speed log. Its flat sensor, without mobile or protruding component, offers unequalled accuracy and robustness.

The ALIZE Speed Log comprises :

- One main display unit IP67 (wall or bracket mounting)
- One NORYL retractable sensor
- One NORYL hullfitting

MAIN FEATURES

- Power supply : 12 V,
- Accuracy after calibration : < 0,5 knots
- Digital full scale : 60 knots

Main features on LCD display :

- distance,
- distance from last reset,
- water temperature,
- average speed,
- gain, zero and damping set up through keyboard,
- chrono function for regatta (10mn or 6mn count up as you wish),
- programmable low alarm,
- brightness control.

SPECIFICATIONS

- Cabinet dim. : 112 x 112 x 28 mm (wall mounting)
- Sensor : $\varnothing 40$ - L = 108 mm,
- Hullfitting : $\varnothing 75$ - H = 95 mm.
- Inputs :
 - Power supply : 12 V
 - RS422 from sensor
- Outputs :
 - RS 422 NMEA 0183,
 - Alarm (free of tension relay),
 - 200 ppnm (free of tension relay).

PERCEGE
VERSION ETRIER
DRILLING FOR
BRACKET MOUNTING

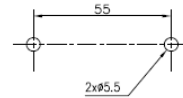

PERCEGE
VERSION CLOISON
DRILLING FOR
WALL MOUNTING

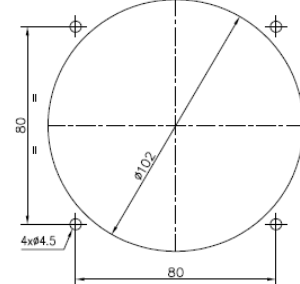

SENSOR

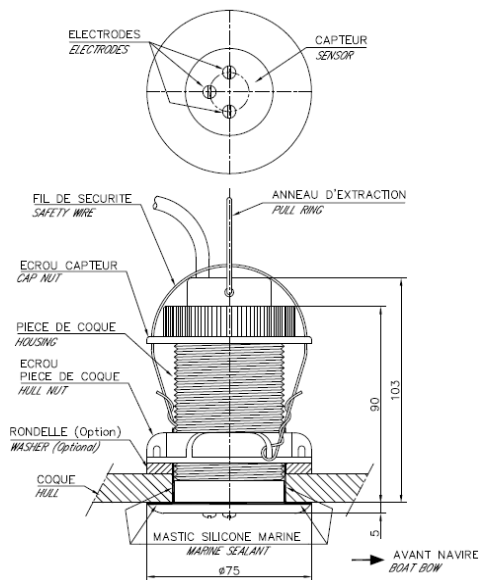

CABINET

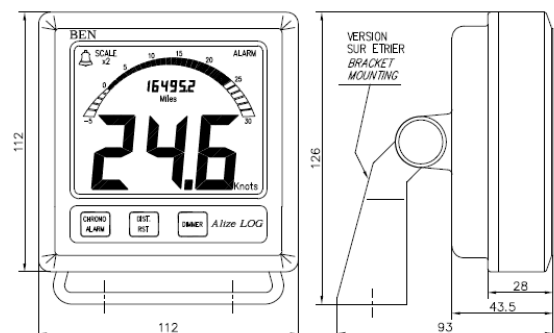

THIS DATA SHEET IS SUBJECT TO ALTERATION WITHOUT NOTICE

DOC045-B

